

LTR	DATE	BY	CHECK	REVISIONS
A	9/24/01			INITIAL DESIGN
B	1/20/03			1/2" & 1/4" CHANGED TO 3/4" CASTING
C	1/22/07			CHANGED TO SQUARE HOUSING
D	3/12/08			CHANGED B DIMENSION SST
E	04/15/10			CHANGED A,C,D DIMENSION SST
F	8/22/12			ADD W3 TO DESCRIPTION

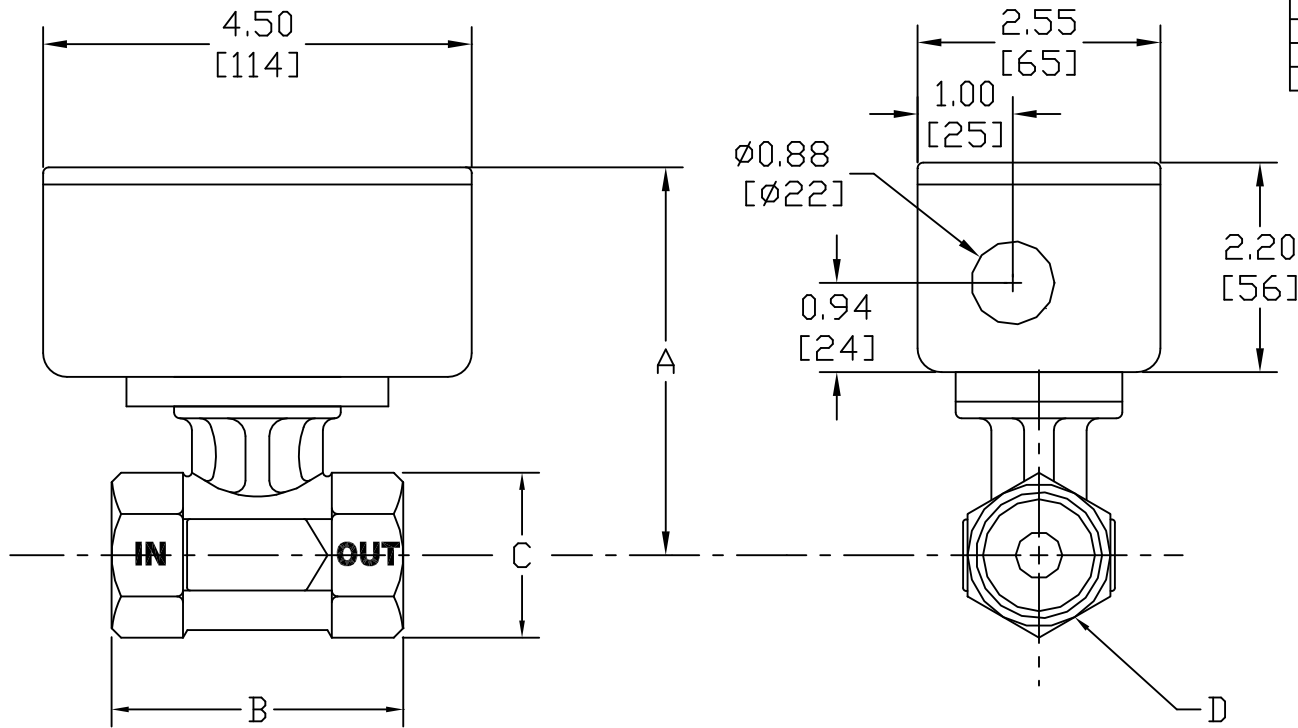

NOTES:
1. DIMENSION FORMAT IS $\frac{\text{in}}{\text{mm}}$

SERIES 1000 & W3 BRONZE

SERIES 1000 & W3 SST

PIPE SIZE		DIMENSION								
		A		B		C		D		
in	mm	in	mm	in	mm	in	mm	in	mm	
0.25	08	3.93	100	3.06	78	1.50	38	1.25	32	hex
0.5	15	3.93	100	3.06	78	1.50	38	1.25	32	hex
0.75	20	3.93	100	3.06	78	1.50	38	1.25	32	hex
1.0	25	4.05	103	3.06	78	1.75	44	1.50	38	hex
1.5	40	4.43	113	3.06	78	2.50	64	2.12	54	hex
2.0	50	4.8	122	3.19	81	3.19	81	2.75	70	hex
3.0	80	5.49	139	4.19	106	4.62	117	4.00	102	hex

PIPE SIZE		DIMENSION								
		A		B		C		D		
in	mm	in	mm	in	mm	in	mm	in	mm	
0.25	08	3.21	82	3.06	78	1.06	27	1.06	27	sq
0.5	15	3.21	82	3.06	78	1.06	27	1.06	27	sq
0.75	20	3.87	98	2.70	69	1.50	38	1.50	38	rnd
1.0	25	3.94	100	2.77	70	1.75	44	1.75	44	rnd
1.5	40	4.43	113	3.27	83	2.38	60	2.38	60	rnd
2.0	50	4.8	122	3.27	83	3.0	76	3.0	76	rnd
3.0	80	5.49	139	4.36	111	4.62	117	4.00	102	rnd

Serving Industry Worldwide



Tel: 201-419-6111
Fax: 201-419-6109
sales@nciflow.com
www.nciflow.com

ITEM	DWG. NO.	DESCRIPTION OF MATERIALS	QTY.
UNLESS OTHERWISE SPECIFIED: DIMENSIONS ARE IN INCHES TOLERANCES		RCM Industries, Inc. 110 MASON CIRCLE CONCORD, CA. 94520 SERIES 1000 & W3 FLOWMETER HOUSING-BODY ASSEMBLY	
FRACTIONS:	±		
.X	±		
.XX	±		
.XXX	±		
ANGLES:	±		
SURFACE FINISH:	±		
DRAWN BY	DATE		
CHECKED BY	9/24/01		
SCALE	1:1	SIZE	C
DWG NO.	6641	REV	F